

500kg, 800kg, 1.6t, 3.2t, 6.3t, 9t LIVER HOIST

6.3t

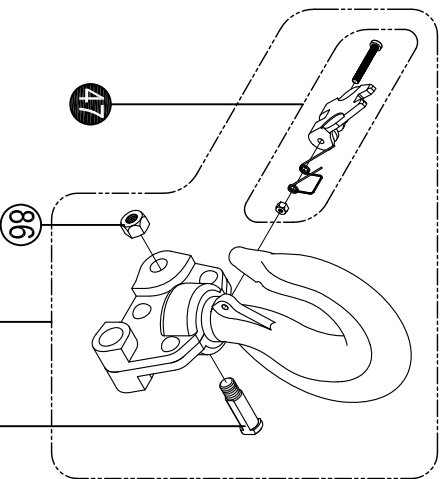

500kg, 800kg, 1.6t, 3.2t

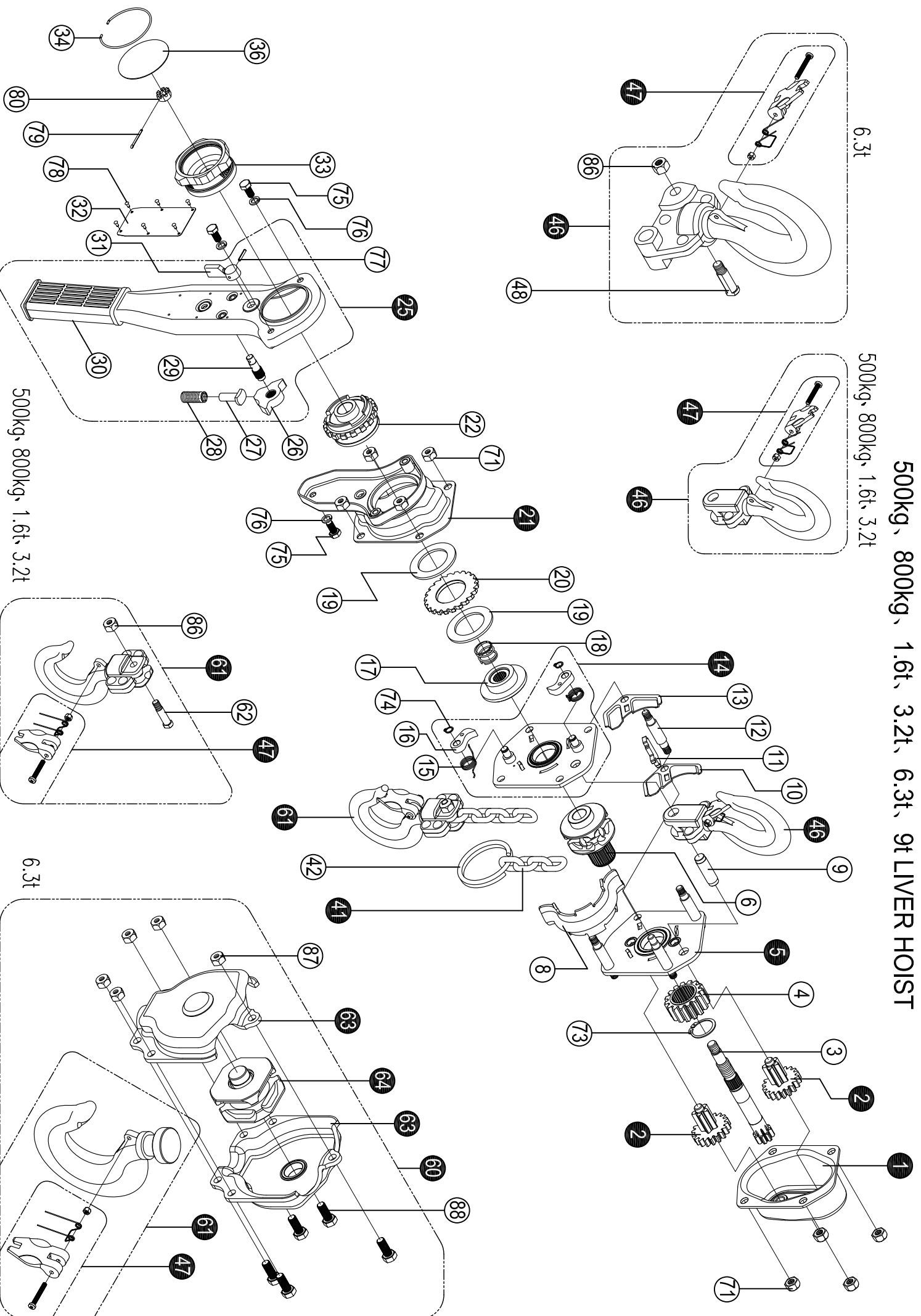
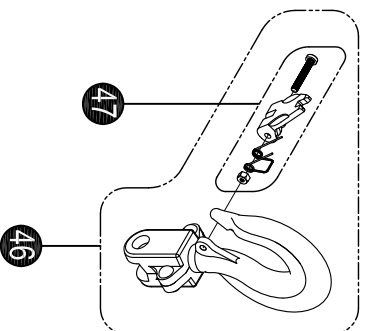

500kg, 800kg, 1.6t, 3.2t

6.3t



Work made easy.

HOISTING & LIFTING

Prod.Id	Description	Pos
4363301	S2/LH-1600KG-1 Gear cover assy	1
4363302	S2/LH-1600KG-2 Disc gear assy	2
4363303	S2/LH-1600KG-3 Drive shaft	3
4363304	S2/LH-1600KG-4 Splined gear	4
4363305	S2/LH-1600KG-5 Right side plate assy	5
4363306	S2/LH-1600KG-6 Load chain sprocket	6
4363308	S2/LH-1600KG-8 Chain guide	8
4363309	S2/LH-1600KG-9 Top hook shaft	9
4363310	S2/LH-1600KG-10 Chain leader A	10
4363311	S2/LH-1600KG-11 Chain stripper	11
4363312	S2/LH-1600KG-12 Stay bolt B	12
4363313	S2/LH-1600KG-13 Chain leader B	13
4363314	S2/LH-1600KG-14 Left side plate assy	14
4363315	S2/LH-1600KG-15 Pawl spring	15
4363316	S2/LH-1600KG-16 Pawl	16
4363317	S2/LH-1600KG-17 Break seat	17
4363318	S2/LH-1600KG-18 Free spring	18
4363319	S2/LH-1600KG-19 Friction plates (2 Discs)	19
4363320	S2/LH-1600KG-20 Ratchet wheel	20
4363321	S2/LH-1600KG-21 Ratchet wheel cover assy	21
4363322	S2/LH-1600KG-22 Changeover ratchet wheel	22
4363325	S2/LH-1600KG-25 Handle assy	25
4363326	S2/LH-1600KG-26 Changeover pawl	26
4363327	S2/LH-1600KG-27 Spring pin	27
4363328	S2/LH-1600KG-28 Changeover spring	28
4363329	S2/LH-1600KG-29 Selector plate shaft	29
4363330	S2/LH-1600KG-30 Hand rubber grip	30
4363331	S2/LH-1600KG-31 Selector plate	31
4363384	XLINE-1600KG-32 Namelate	32
4363333	S2/LH-1600KG-33 Hand wheel	33
4363334	S2/LH-1600KG-34 Steel wire retainer	34
4363386	XLINE-1600KG-36 Hand wheel nameplate	36
4363342	S2/LH-1600KG-42 Chain ring	42
4363346	S2/LH-1600KG-46 Top hook assy	46
4363347	S2/LH-1600KG-47 Safety latch assy	47
4363361	S2/LH-1600KG-61 Bottom hook assy	61
4363362	S2/LH-1600KG-62+86 Bottom hook pin+nut	62
4363371	S2/LH-1600KG-71 Metal lock nut M10	71
4363373	S2/LH-1600KG-73 Circlip M30	73
4363374	S2/LH-1600KG-74 Circlip M9	74
4363375	S2/LH-1600KG-75 Bolt M8×14	75
4363376	S2/LH-1600KG-76 Light spring washer 8	76



HOISTING & LIFTING

Work made easy.

4363377	S2/LH-1600KG-77 spring pin 3×18	77
4363378	S2/LH-1600KG-78 Nameplate rivet 2.5×6	78
4363379	S2/LH-1600KG-79 Split pin 2.5×25	79
4363380	S2/LH-1600KG-80 Hexagon recess nut M10	80